

- Legend**
- Approximate Study
  - Detailed Study
  - Limited Detail Study
  - Redelineation Study
  - Streams
  - Major Roads
  - Roads
  - Railroads
  - Community Boundaries

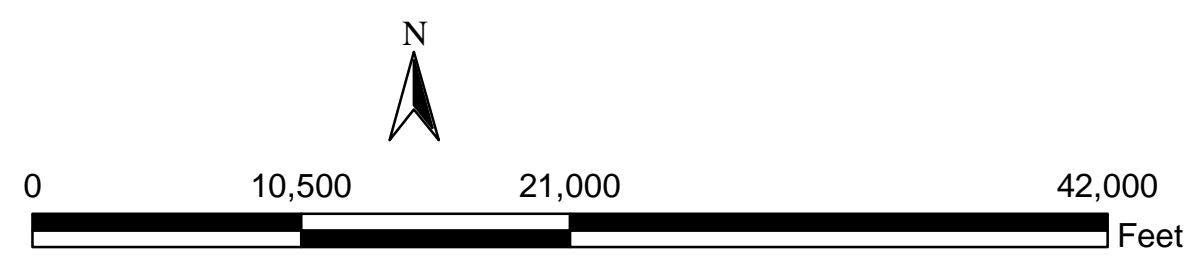

NATIONAL FLOOD INSURANCE PROGRAM

COUNTYWIDE FLOOD INSURANCE STUDY

**MONROE COUNTY, MISSISSIPPI AND INCORPORATED AREAS**

SCOPING REPORT

SUBMISSION BY:  
MGI, LLC

DATE:  
MAY 23, 2007

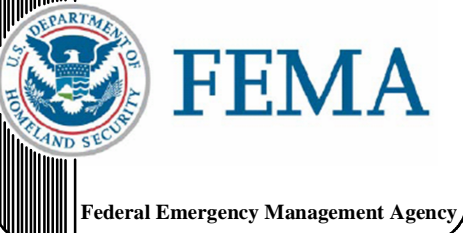

Federal Emergency Management Agency